

ALTIX IMHub

INTERNATIONAL MANUFACTURERS' HUB

AN INCUBATOR AND ACCELERATOR FOR INTERNATIONAL GROWTH
MINDED COMPANIES ENTERING THE NORTH AMERICAN MARKET.

ALTIX IMHub – International Manufacturers’ Hub – is an **incubator and accelerator** that offers international industrial manufacturing and technology companies a **flexible, turnkey solution to set-up and grow your company in North America.**

Strategically located in the Midwest tri-state area where the States of Ohio, Kentucky, and Indiana converge, ALTIX IMHub is the perfect location to launch your business in North America.

Within a 600 miles radius (one day trucking / 90-minute flight) you will have access to:

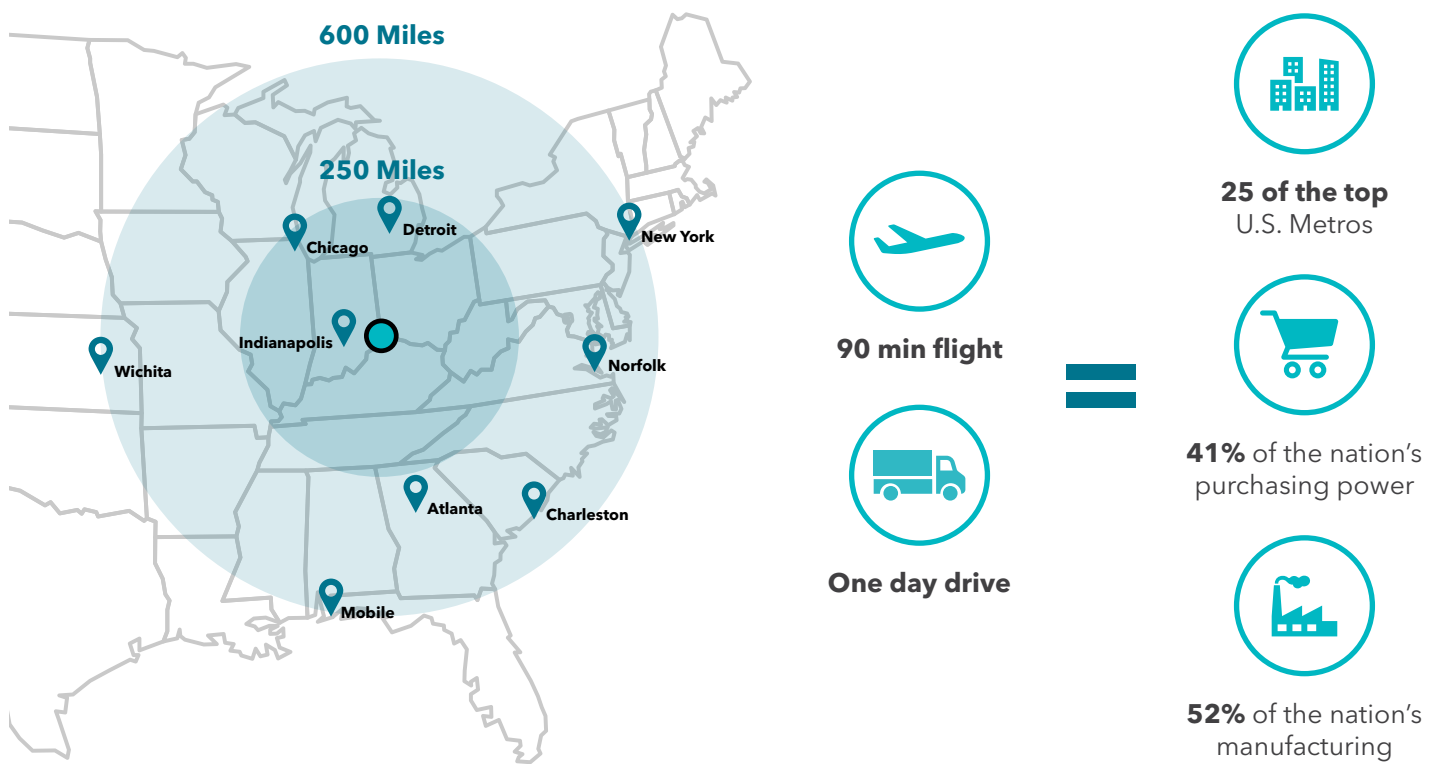

The U.S. offers the world's largest market under one flag, with a common language, a single currency, and a reliable legal system. However, companies expanding in the U.S. often underestimate the complexity of this vast and ultra-competitive market.

The United States of America is in fact, a federation of 50 different legal and tax systems,

spread over 4 time zones, with extreme ranges of climates and population densities, and a great diversity of cultures and purchasing power.

To minimize risk and costly setbacks of a failed expansion in the U.S., ALTIX IMHub helps international industrial companies develop and implement winning market entry and expansion strategies in addition to domiciliation solutions.

FLEXIBLE COST-EFFECTIVE TURNKEY SOLUTIONS TO SET-UP AND GROW U.S. SUBSIDIARIES.

ALTIX IMHub offers a wide range of **cost-effective domiciliation solutions** ranging from a mailbox / U.S. mailing address to private or shared office space, office packages, conference and meeting rooms, storage & warehouse in a **supportive multi-cultural business environment**.

A-la-carte business support in HR, Sales & Marketing, IT, Market Research, and Finance & Accounting are available to support you every step of the way, so you can focus your limited resources on growing your company, in one of the most dynamic and competitive markets in the world.

DOMICILIATION SERVICES



U.S. Mailing Address



U.S. Premier Logistics & Industrial Location



Conference / Meeting Rooms



Extensive Business & Industry Network



Office Space Private / Shared



Office Package



High-Speed Internet



Kitchen Area



Free Parking

A-LA-CARTE BUSINESS SUPPORT



Human Resources



Sales & Marketing



Information Technology



Storage & Warehouse Solutions



Market Research



Finance & Accounting

ALTIX IMHub is a specialized offering of Altix Consulting, a middle market international industrial champions' management consulting partner. Altix Consulting provides business strategy, technology and innovation, and operational excellence support, in the world of advanced manufacturing and international supply chain.

The Altix team of senior industry advisors can help you **accelerate your North America market entry and expansion** with proven concepts and exceptional business, industry, and government networks, introducing you to qualified resources, business partners, and much more!

Altix Consulting and ALTIX IMHub provide a **stimulating business environment** of international languages and cultures, growth-minded people, and an exceptional business network.

FLOOR PLAN: ALTIX HEADQUARTERS AND ALTIX IMHUB

ALTIX IMHub provides up to 300 square meters of private and shared office space in addition to shared meeting rooms and kitchen. The space is move-in ready so you can get-to-work quickly on growing your business. The location is in close proximity of restaurants, housing and hotels.

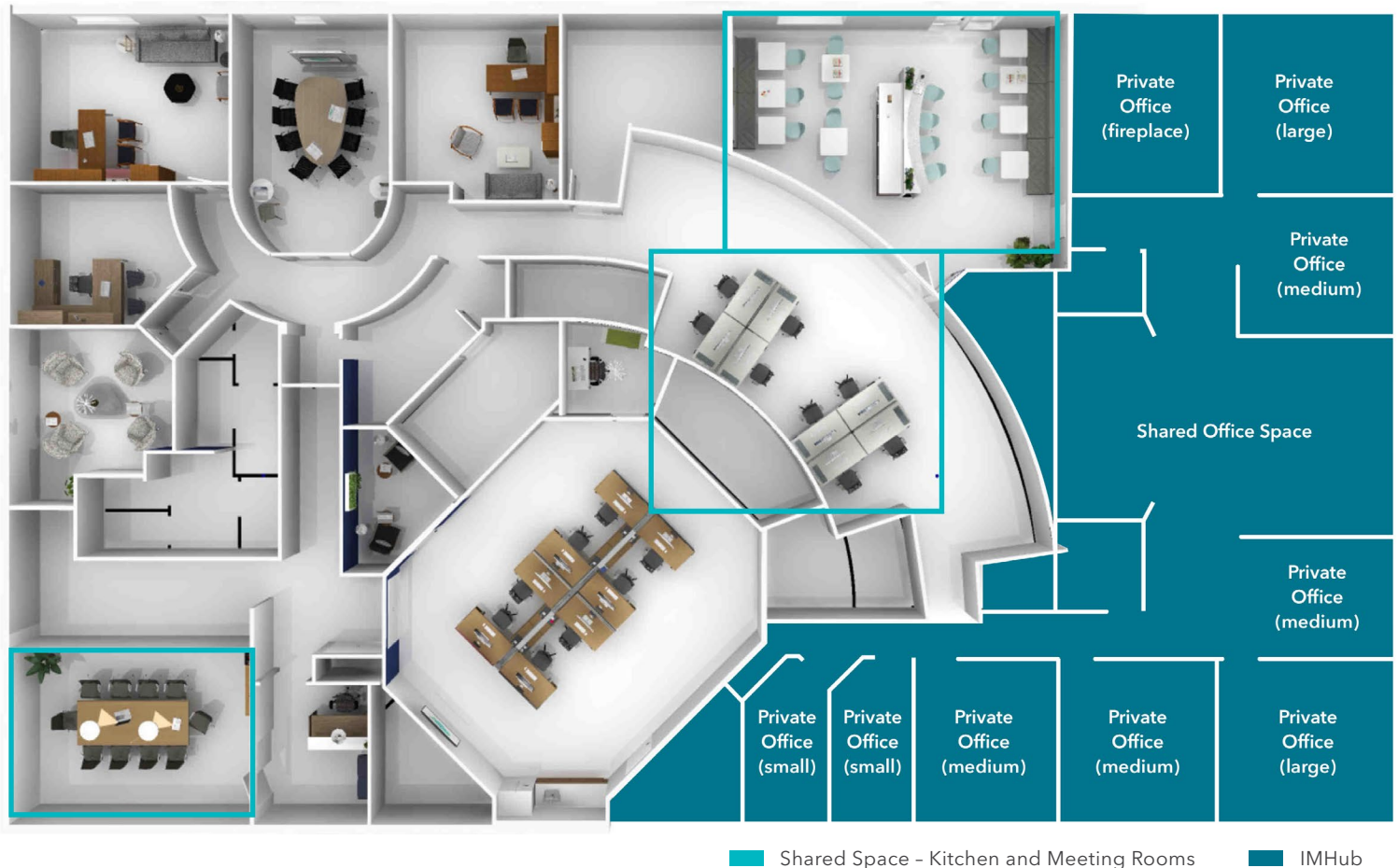

To find out more about how ALTIX IMHub can work for you, please contact:

Anne Cappel Chief Marketing Officer, Altix Consulting

anne.cappel@altixconsulting.com | +1 513 310 9500

Altix Consulting, 6402 Thornberry Court, Mason, OH 45040 (Greater Cincinnati USA)

ABOUT ALTIX:

We are the middle market international industrial champions' management consulting partner. We provide business strategy, technology and innovation, and operational excellence support, in the world of advanced manufacturing and international supply chain. For more information on ALTIX Consulting go to: www.altixconsulting.com.